





Import a Cross Stitch Chart

This exercise is taken from the Using the Cross Stitch Design Assistant chapter of the PREMIER+™ 2 Cross Stitcher Reference Guide for Mac®.

- 1 In PREMIER+™ 2 Cross Stitcher, choose File > New and the Design Options page of the Cross Stitch Design Assistant appears.
- 2 Select Load Picture for New Cross Stitch Design and click Continue. The Choose Picture page of the Cross Stitch Design Assistant appears.
- 3 Click Select File and the Open dialog appears.
Note: Click Other Sources or a Social Media button to load a picture directly from your phone, scanner or camera.
- 4 Browse to the folder Home/Premier+2/Samples/Cross/Pics, click the file named 'Bells phone photo.jpg' and click Open. The picture is previewed in the assistant.
- 5 Click Continue and the Rotate and Crop Picture page appears.
- 6 Click to select Perspective Correction . The crop handles for selection become red.
- 7 Move the pointer over one of the red crop handles in the corner. The pointer changes to a diagonal double-headed arrow .
- 8 Drag the red corner handles so that the crop lines frame the grid for the cross stitch chart. A version of the picture showing the perspective changes that you made appears in the preview area.

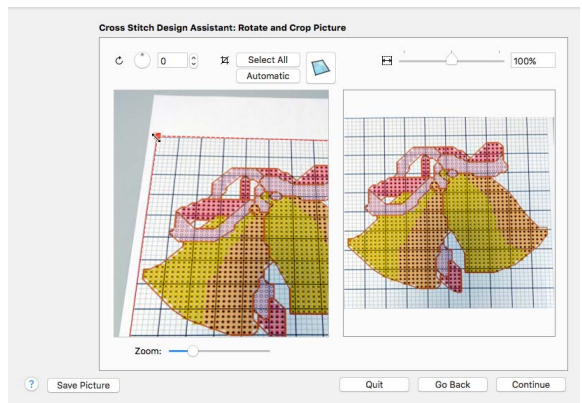
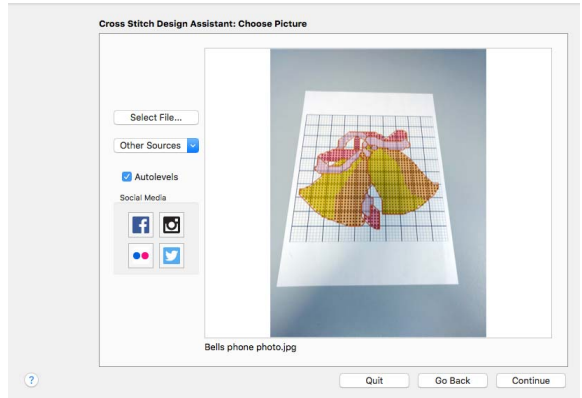

Note: When you take a photo of a cross stitch chart, hold the phone or camera so as to avoid reflected light and shadow on your subject, and use a high resolution setting. To get the best possible results, use a scanner.

9 Use the Zoom bar for making fine adjustments to the edges of the selected area.
Note: Use Stretch Picture  to ensure that the grid squares are actually square.

10 Click Continue and the Design Size page appears.

11 Change the Width and Height numbers to match the number of squares in the grid for your chart.

In this case the grid is 50 x 50, but the settings will probably show 51 x 50.

12 Deselect Proportional  to attain an exact match.

Ideally, the grid on the screen should now fit over the grid in the picture.

Note: If needed, click Go Back and adjust the selection area further, then try to match the two grids again.

13 Click Done to load the picture onto the work area. You are now ready to create a cross stitch design over your loaded chart.

14 Use Add Color  in the Design Panel to add the thread colors from your chart.

15 Starting with the backstitch lines (and any French Knots), create stitches over the chart image, using the colors and their symbols as a guide.

Note: You may find it easier to work in 2D View.

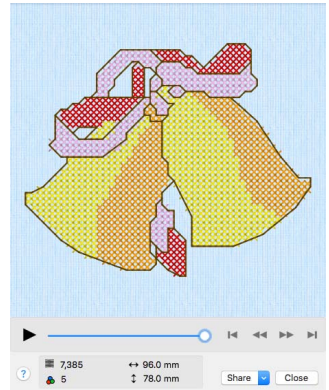
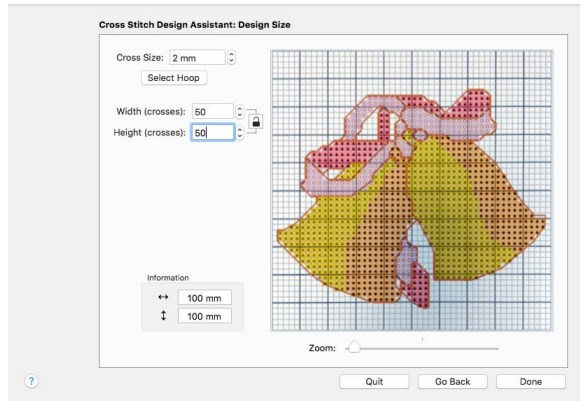

VIKING, PFAFF, PREMIER+ and 6D are trademarks of Singer Sourcing Limited LLC. HUSQVARNA is the trademark of Husqvarna AB. All trademarks are used under license by VSM Group AB. © 2018 Singer Sourcing Limited LLC. All rights reserved.